

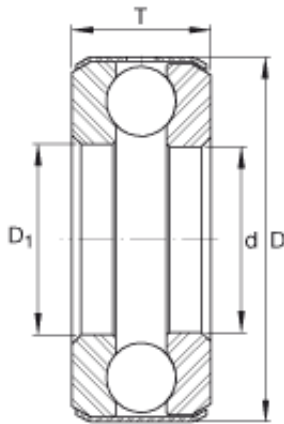

Timken BEARINGS INDUSTRY



INA B33 thrust ball bearings

Bearing No. B33

Size	63.5x100.813x22.225 mm
Bore Diameter	63,5 mm
Outer Diameter	100,813 mm
Width	22,225 mm
d	2 1/2 inch
d	63,5 mm
D	3,969 inch
D	100,813 mm
T	0,875 inch
T	22,225 mm
D ₁	2,531 inch
m	1,343 lbs / Weight
m	0,609 kg / Weight
C _a	14300 lbf / Dynamic load rating (axial)
C _a	64000 N / Dynamic load rating (axial)
C _{0a}	39500 lbf / Static load rating (axial)
C _{0a}	176000 N / Static load rating (axial)
Category	Thrust Ball Bearing
Inventory	1.0
Manufacturer Name	SCHAEFFLER GROUP
Minimum Buy Quantity	N/A
Weight / Kilogram	0.73
EAN	4012802032994

B33 Bearing 2D drawings and 3D CAD models



Timken BEARINGS INDUSTRY

Product Group	B00308
Rolling Element	Ball Bearing
Thrust Bearing	Yes
Single or Double Direction	Single Direction
Banded	Yes
Precision Class	ABEC 1 ISO P0
Component Description	Roller Assembly Plus Raceways
Other Features	Single Row Deep Groove Medium Cross Section Grooved Race Non Separable Full Complement Standard Oil Hole in Band
Long Description	2-1/2" Bore 1; 2-17/32" Bore 2; 3-31/32" Outside Diameter; 7/8" Height; Ball Bearing; Single Direction; Banded; ABEC 1 ISO P0 Precision
Inch - Metric	Inch
Category	Thrust Ball Bearings
UNSPSC	31171507
Harmonized Tariff Code	8482.10.50.08
Noun	Bearing
Keyword String	Ball Thrust
Manufacturer URL	http://www.ina.com
Manufacturer Item Number	B33
Weight / LBS	1.343
Bore 1	2.5 Inch 63.5 Millimeter
Height	0.875 Inch 22.225 Millimeter
Outside Diameter	3.969 Inch 100.813 Millimeter
Bore 2	2.531 Inch 64.287 Millimeter



Timken BEARINGS INDUSTRY

Overall Height with Aligning Washer	0 Inch 0 Millimeter
--	-----------------------