

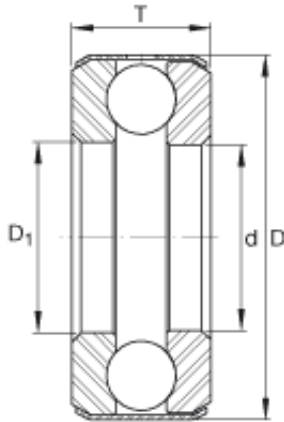

Timken BEARINGS INDUSTRY



INA B29 thrust ball bearings

Bearing No. B29

B29 Bearing 2D drawings and 3D CAD models

Size	57.15x80.747x22.22 mm
Bore Diameter	57,15 mm
Outer Diameter	80,747 mm
Width	22,22 mm
d	2 1/4 inch
d	57,15 mm
D	3,719 inch
D	80,747 mm
T	0,875 inch
T	22,22 mm
D ₁	2,281 inch
m	1,235 lbs / Weight
m	0,56 kg / Weight
C _a	14000 lbf / Dynamic load rating (axial)
C _a	62000 N / Dynamic load rating (axial)
C _{0a}	36000 lbf / Static load rating (axial)
C _{0a}	160000 N / Static load rating (axial)
Category	Thrust Ball Bearing
Inventory	0.0
Manufacturer Name	SCHAEFFLER GROUP
Minimum Buy Quantity	N/A
Weight / Kilogram	0.671
EAN	4012802032987



Timken BEARINGS INDUSTRY

Product Group	B00308
Rolling Element	Ball Bearing
Thrust Bearing	Yes
Single or Double Direction	Single Direction
Banded	Yes
Precision Class	ABEC 1 ISO P0
Component Description	Roller Assembly Plus Raceways
Other Features	Single Row Deep Groove Medium Cross Section Grooved Race Non Separable Full Complement Standard Oil Hole in Band
Long Description	2-1/4" Bore 1; 2-9/32" Bore 2; 3-23/32" Outside Diameter; 7/8" Height; Ball Bearing; Single Direction; Banded; ABEC 1 ISO P0 Precision
Inch - Metric	Inch
Category	Thrust Ball Bearings
UNSPSC	31171507
Harmonized Tariff Code	8482.10.50.08
Noun	Bearing
Keyword String	Ball Thrust
Manufacturer URL	http://www.ina.com
Manufacturer Item Number	B29
Weight / LBS	1.235
Height	0.875 Inch 22.225 Millimeter
Overall Height with Aligning Washer	0 Inch 0 Millimeter
Bore 1	2.25 Inch 57.15 Millimeter
Bore 2	2.281 Inch 57.937 Millimeter



Timken BEARINGS INDUSTRY

Outside Diameter

3.719 Inch | 94.463
Millimeter