

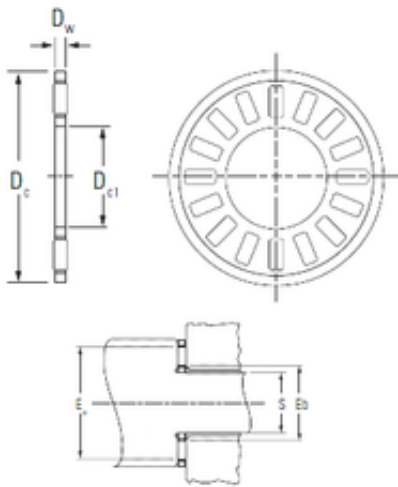

# Timken BEARINGS INDUSTRY



## KOYO NTA-3648 needle roller bearings

Bearing No. NTA-3648

Size	57.15x76.2x1.984 mm
Bore Diameter	57,15 mm
Outer Diameter	76,2 mm
Width	1,984 mm
d	57,15 mm
D	76,2 mm
T	1,984 mm
Ea	71,628 mm
Eb	59,44 mm
Weight	0,017 Kg
Basic dynamic load rating (C)	24,78 kN
Basic static load rating (C0)	142,34 kN
Category	Thrust Roller Bearing
Inventory	107.0
Manufacturer Name	KOYO
Minimum Buy Quantity	N/A
Weight / Kilogram	0.016
EAN	0605790213847
Product Group	B04144
Rolling Element	Needle Roller Bearing
Self Aligning	No
Component Description	Roller Assembly Only
Thrust Bearing	Yes
Single or Double Direction	Single Direction
Banded	No
Cage Material	Steel

NTA-3648 Bearing 2D drawings and 3D CAD models



## Timken BEARINGS INDUSTRY

Precision Class	ABEC 1   ISO P0
Other Features	Single Row   Two Piece Cage
Long Description	2-1/4" Bore 1; 2-1/4" Bore 2; 3" Outside Diameter; 5/64" Height; Needle Roller Bearing; Single Direction; Not Self Aligning; Not Banded; Steel Cage; ABEC 1   ISO P0; Roller Assembl
Inch - Metric	Inch
Category	Thrust Roller Bearings
UNSPSC	31171500
Harmonized Tariff Code	8482.99.25.40
Noun	Roller Assembly
Keyword String	Thrust Needle
Manufacturer URL	<a href="http://www.koyousa.com">http://www.koyousa.com</a>
Manufacturer Item Number	NTA-3648
Weight / LBS	0.038
Bore 2	2.25 Inch   57.15 Millimeter
Overall Height with Aligning Washer	0 Inch   0 Millimeter
Bore 1	2.25 Inch   57.15 Millimeter
Height	0.078 Inch   1.981 Millimeter
Outside Diameter	3 Inch   76.2 Millimeter
Bearing No.	NTA-3648
Dc1	57.15
Dc	76.2
Dw	1.984
Ca	24.78
C0a	142.34
Cu	14.6
Limiting speeds(min-1)	5600
(Refer.)Mass(kg)	0.017



## Timken BEARINGS INDUSTRY

Washer designation	TRA-3648
d1	76.20
h(max)	0.81
h(min)	0.76
S(max)	57.15
S(min)	57.07
H	76.99
(Refer.)Washer mass(kg)	0.012