

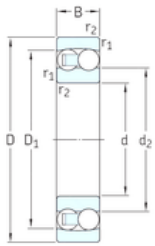

Timken BEARINGS INDUSTRY



Cylindrical bore



Tapered bore

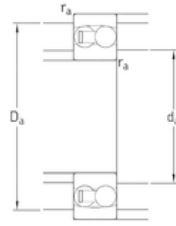

35 mm x 80 mm x 31 mm SKF 2307ETN9 self aligning ball bearings

Bearing No. 2307ETN9

2307ETN9 Bearing 2D drawings and 3D CAD models

Size	35x80x31 mm
Bore Diameter	35 mm
Outer Diameter	80 mm
Width	31 mm
d	35 mm
D	80 mm
B	31 mm
C	31 mm
d2	46,5 mm
r1 min.	1,5 mm
r2 min.	1,5 mm
D1	68,4 mm
da min.	44 mm
Da max.	71 mm
ra max.	1,5 mm
Weight	0,68 Kg
Basic dynamic load rating (C)	39,7 kN
Basic static load rating (C0)	11,2 kN
Fatigue load limit (Pu)	0,59
Reference speed	16000 r/min
Limiting speed	12000 r/min
Calculation factor (e)	0,46
Calculation factor (kr)	0,05
Calculation factor (Y0)	1,4
Calculation factor (Y1)	1,35



Timken BEARINGS INDUSTRY