

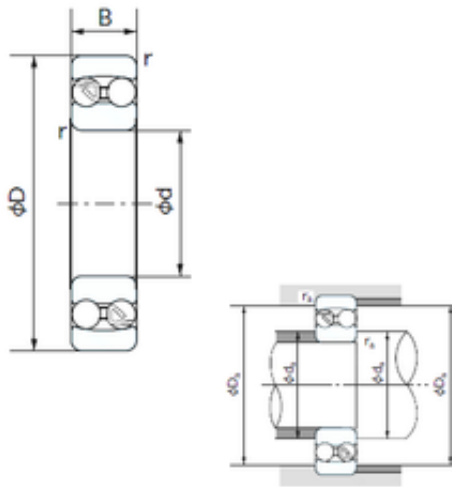

Timken BEARINGS INDUSTRY



20 mm x 52 mm x 15 mm NACHI 1304 self aligning ball bearings

Bearing No. 1304

1304 Bearing 2D drawings and 3D CAD models

Size	20x52x15 mm
Bore Diameter	20 mm
Outer Diameter	52 mm
Width	15 mm
d	20 mm
D	52 mm
B	15 mm
C	15 mm
r1 min.	1.1 mm
da min.	26.5 mm
Da max.	45.5 mm
ra max.	1.0 mm
Weight	0.163 Kg
Basic dynamic load rating (C)	12,4 kN
Basic static load rating (C0)	3,3 kN
(Grease) Lubrication Speed	12000 r/min
(Oil) Lubrication Speed	15000 r/min
Calculation factor (e)	0.30
Calculation factor (Y0)	2.22
Calculation factor (Y1)	2.12
Category	Self Aligning Ball Bearings
Inventory	0.0
Manufacturer Name	NACHI
Minimum Buy Quantity	N/A
Weight / Kilogram	0



Timken BEARINGS INDUSTRY

Product Group	B00152
Mounting Method	Shaft
Enclosure	Open
Rolling Element	Ball Bearing
Cage Material	Steel
Precision Class	ABEC 1 ISO P0
Internal Clearance	C0-Medium
Number of Rows of Balls	Double Row
Other Features	Allowable Misalignment 3 Deg
Long Description	20MM Bore; Shaft Mount; 52MM Outside Diameter; 15MM Inner Race Width; 15MM Outer Race Width; Open; Steel Cage; Double Row of Balls; ABEC 1 ISO P0; C0-Medium
Inch - Metric	Metric
Category	Self Aligning Ball Bearings
UNSPSC	31171532
Harmonized Tariff Code	8482.10.50.68
Noun	Bearing
Keyword String	Self Aligning
Manufacturer URL	http://www.nachi.com
Weight / LBS	0.35935
Outer Race Width	0.591 Inch 15 Millimeter
Inner Race Width	0.591 Inch 15 Millimeter
Outside Diameter	2.047 Inch 52 Millimeter
Bore	0.787 Inch 20 Millimeter