

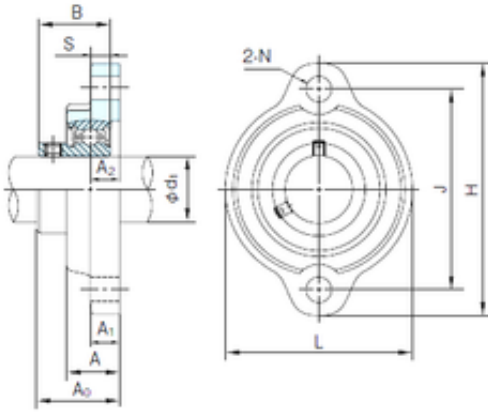

Timken BEARINGS INDUSTRY

NACHI BLFL1J bearing units



Bearing No. BLFL1J

Bore Diameter	12 mm
d	12 mm
A0	25.5 mm
A	18 mm
A1	9.5 mm
B	22 mm
H	81 mm
J	63.5 mm
L	56 mm
N	7 mm
S	6 mm
Bolt (G)	M 6
A2	9.5 mm

BLFL1J Bearing 2D drawings and 3D CAD models